

LOW END ASSEMBLY
SINGLE & DOUBLE

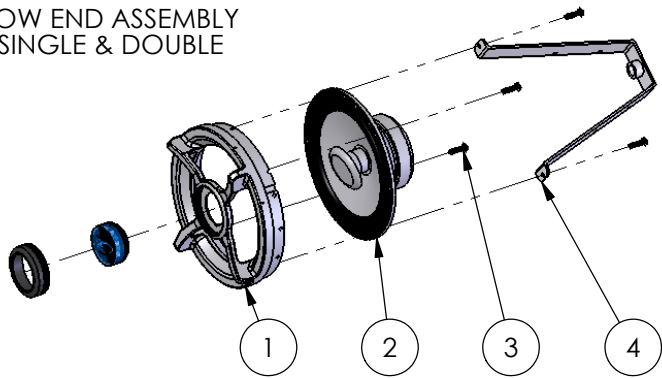

HIGH END
SINGLE ASSEMBLY

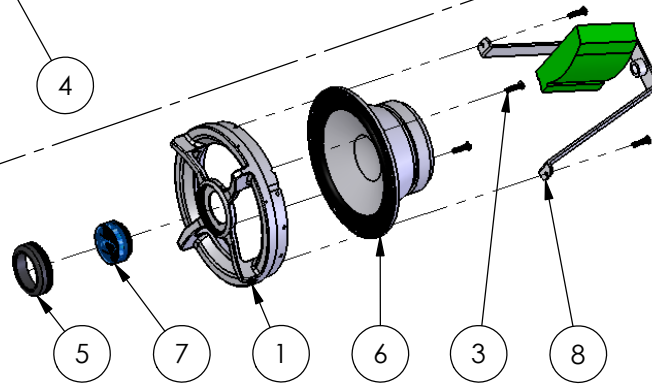

HIGH END
DOUBLE ASSEMBLY

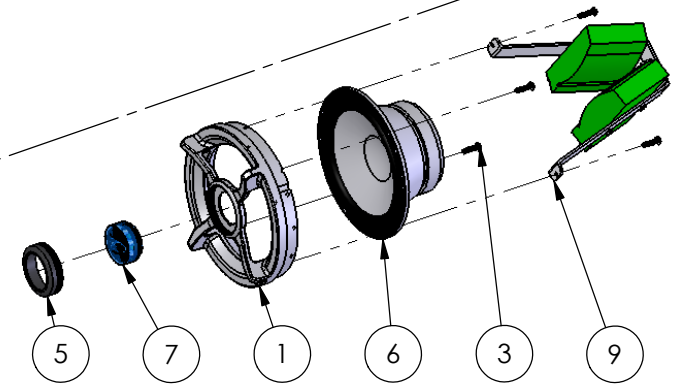

| ITEM NO. | PART NUMBER | MATERIAL | LOW END/QTY. | HIGH END DOUBLE/QTY. | HIGH END SINGLE/QTY. |
|----------|---|-----------------------|--------------|----------------------|----------------------|
| 1 | RWA-050905-E5-REV-E23-(Speaker Grill) | CHROME PLATED PLASTIC | 1 | 1 | 1 |
| 2 | PHOENIX GOLD OCTANE R COAXIAL 6.0 INCH mock up | STOCK ITEM | 1 | - | - |
| 3 | BTNHD_~190-24 UNC_0~75_SIMP | STAINLESS STEEL | 4 | 4 | 4 |
| 4 | RWA-130905-E3-REV-E2-(Larger Spine & Cross Over Assembly) LOW END | SEE SUB ASSEMBLY BOM | 1 | - | - |
| 5 | RWA-280705-E6-REV-E2-(Internal Tweeter & LED Housing) | PLASTIC | 1 | 1 | 1 |
| 6 | PHOENIX GOLD OCTANE R 6.0 INCH mock up | STOCK ITEM | - | 1 | 1 |
| 7 | RWA-061005-E1-REV-E0-(Speaker LED Assembly) | SEE SUB ASSEMBLY BOM | 1 | 1 | 1 |
| 8 | RWA-130905-E3-REV-E2-(Larger Spine & Cross Over Assembly) SINGLE HIGH END | SEE SUB ASSEMBLY BOM | - | - | 1 |
| 9 | RWA-130905-E3-REV-E2-(Larger Spine & Cross Over Assembly) DOUBLE HIGH END | SEE SUB ASSEMBLY BOM | - | 1 | - |

REVISION NOTES: PREVIOUS DRAWING#-RWA-221105-E5-REV-E0-(Larger Grill Speaker Spine BOM) MID END PRICE POINT WAS REMOVED. NOW THERE IS ONLY HIGH END & LOW END PRICE POINTS. LOW END TWEETER HAS BEEN REPLACED BY LED ASSEMBLY. LOW END & HIGH END USE THE SAME GRILL.

UNLESS OTHERWISE SPECIFIED:

DIMENSIONS ARE IN INCHES
TOLERANCES:

DECIMAL: x. ± 0.06
 x.x ± 0.03
 x.xx ± 0.015
 x.xxx ± 0.005
 FRACTIONAL: xx x/x ± 1/16"
 x x/x ± 1/32"
 x/x ± 1/64"
 ANGULAR: ± 0.5°

R O S W E L L .

RWA-221105-E5-REV-E1-(Larger Grill Speaker Spine BOM)

BRAND-DATE-DESIGNER-REVISION-(Description)

SCALE: 1:8

REVISION DATE: 15/12/05

PROPRIETARY AND CONFIDENTIAL

THE INFORMATION CONTAINED IN THIS DRAWING IS THE SOLE PROPERTY OF ROSWELL WAKE AIR. ANY REPRODUCTION IN PART OR AS A WHOLE WITHOUT THE WRITTEN PERMISSION OF ROSWELL WAKE AIR IS PROHIBITED.

DRAWN BY:
ERIC GAGNON

Process:
SEE INDIVIDUAL PART DRAWING

MATERIAL:
SEE INDIVIDUAL PART DRAWING

FINISH:
SEE INDIVIDUAL PART DRAWING

DO NOT SCALE DRAWING