

| ITEM NO. | PART NUMBER                                   | PROCESS               | MATERIAL         | FINISH           | QTY. |
|----------|---|-----------------------|------------------|------------------|------|
| 1        | RWA-160106-G1-REV-G1-(Roswell Medallion)      | Die Cast              | 6061 Alloy       | Chrome plated    | 1    |
| 2        | RWA-120906-E1-REV-G9-(Right Tine)             | See Sub Assembly      | See Sub Assembly | See Sub Assembly | 1    |
| 3        | FLH-SCH-82_~250-20 UNC_1_SIMP                 | STOCK ITEM            | Stainless Steel  | RAW              | 4    |
| 4        | COB-201205-G7-REV-G0-(Custom Locking Pin)     | STOCK ITEM            | Stainless Steel  | RAW              | 2    |
| 5        | SSCR-HEX-CUP_~190-24 UNC_0~375_HELI           | STOCK ITEM            | Stainless Steel  | RAW              | 2    |
| 6        | SCH_~250-20 UNC_0~75_SIMP                     | STOCK ITEM            | Stainless Steel  | RAW              | 4    |
| 7        | RWA-201205-G5-REV-E2-(SI Caddy Backing Plate) | Die Cast/CNC Machined | 6061 Alloy       | Highly Polished  | 1    |
| 8        | RWA-120906-E1-REV-G8-(Left Tine)              | See Sub Assembly      | See Sub Assembly | See Sub Assembly | 1    |

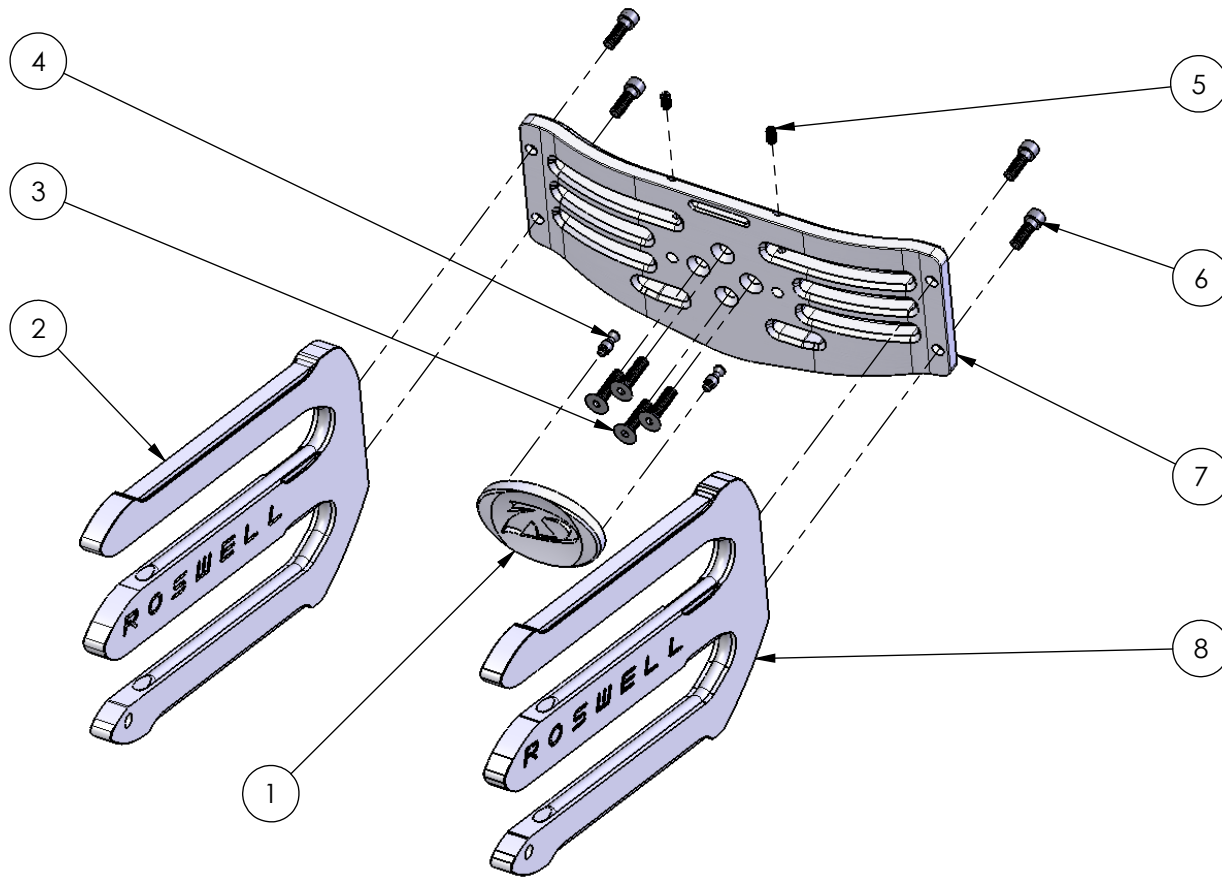

REVISION NOTES:

**PROPRIETARY AND CONFIDENTIAL**  
 THE INFORMATION CONTAINED IN THIS DRAWING IS THE SOLE PROPERTY OF ROSWELL WAKE AIR. ANY REPRODUCTION IN PART OR AS A WHOLE WITHOUT THE WRITTEN PERMISSION OF ROSWELL WAKE AIR IS PROHIBITED.

|                      |               |           |               |
|----------------------|---------------|-----------|---------------|
| DRAWN BY:            | egagnon       | MATERIAL: | SEE BOM TABLE |
| PROCESS:             | SEE BOM TABLE | FINISH:   | SEE BOM TABLE |
| DO NOT SCALE DRAWING |               |           |               |

UNLESS OTHERWISE SPECIFIED:  
 DIMENSIONS ARE IN INCHES  
 TOLERANCES:  
 DECIMAL: x. ± 0.06  
 x.x ± 0.03  
 x.xx ± 0.015  
 x.xxx ± 0.005  
 FRACTIONAL: xx x/x ± 1/16"  
 x x/x ± 1/32"  
 x/x ± 1/64"  
 ANGULAR: ±0.5°



RWA-201205-G6-REV-E1-(SI Caddy Rack Assembly BOM)

BRAND-DATE-DESIGNER-REVISION-(Description)

SCALE: 1:4 REVISION DATE: Tuesday, December 11, 2007