

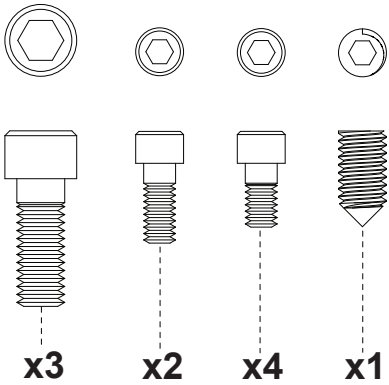

### Mirror Arm Hardware



### Tools Required

3/16" Allen Key  
5/16" Allen Key

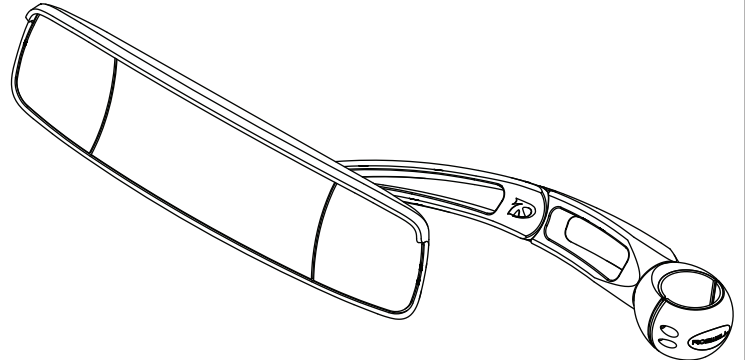
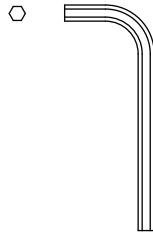

### A

Assemble the 4 bolts through the mirror arm joint to prevent pivoting.

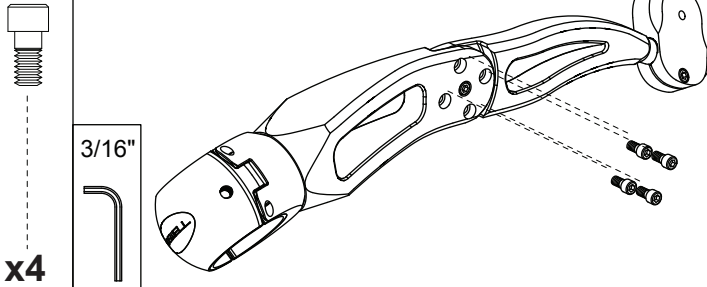

### B

Assemble the mirror to the arm as shown.

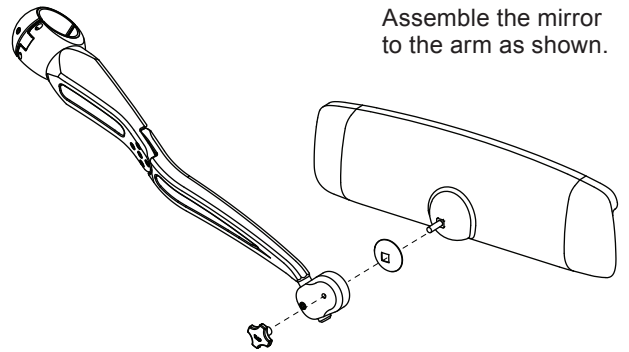

### C

1) Remove the 2 bolts that allow the clamp head to open. Remove both custom inserts.

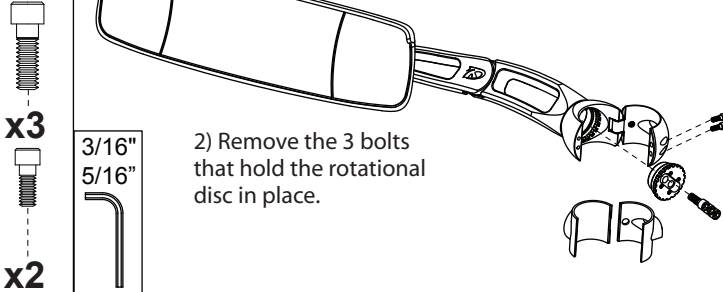

2) Remove the 3 bolts that hold the rotational disc in place.

### D

Test fit the mirror to your tower. Find a position that is comfortable for your viewing. Locate the rotational disc to the nearest available position and secure in place with the 3 bolts from step C. Apply Loctite to each bolt.

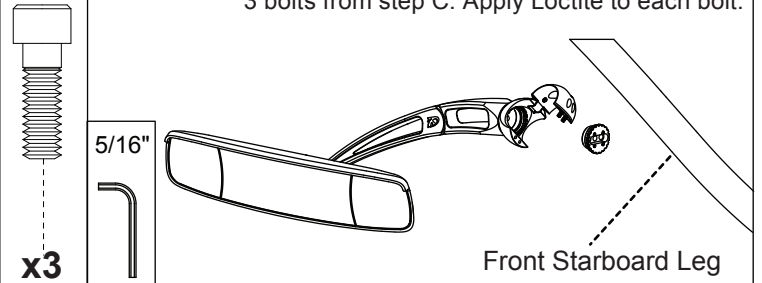

### E

Place the appropriate custom insert in the clamp based on the diameter of tubing your tower is made of. Either 1.66", 1.9" or 2.375". Assemble the clamp to the tower with the 2 bolts. Apply Loctite to each bolt.

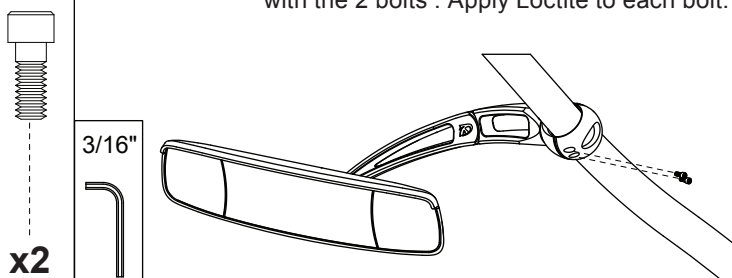

### F

Make final adjustments by rotating mirror and/or the arm. You need a 3/16" allen key to do arm adjustments. **Ensure Loctite has been applied to all bolts.** After all adjustments are made tighten the final set screw through the clamp as much as possible.

